

CINEY



CINEY

In town or in the countryside

The arrival of railways in the industrial area has deeply influenced the urban development of Ciney. The town is spreading out of his rampart and is developing progressively toward the train station. This urbanization focused along the 'rue du commerce' allows the association of the commercial activities with the main pedestrian fluxes. To initiate a change of the way the city is used and perceived, a new way to wander about between the historical center and the train station is suggested. This greenway offers a renewed gaze of Ciney by partially using existing pathways. It allows the binding of three landscapes: the park located above the quarries, the greenway on the border of the Leignon and the 'parc de la haute' situated on the other side of the rails.

The route proposed goes from east to west through the site of the project and crosses transversally various context: a topographical rupture at the ancient quarries level, the «quai de l'industrie» connected with Ciney's forges, the greenway, the Leignon, a new roadway for trucks coming from the concrete factory and finally the railways. This different elements punctuate and give themes to the different sequences. The creation of the greenway and thematically different spaces rely on the context by following their close surrounding. The project aims to integrate the rails to the city while suggesting a new pedestrian trail between the center and the train station.



CINEY

Program :

- Fitness trail
- Pier of observation
- Panoramic table

Typology :

Overhanging open space, lookout

Strategy :

- To reconnect the park with the town
- To promote the respect from the user

Located on the significant topographical fracture due to ancient quarries of the forges, this place is composed on its current state of an important wooded area. The project intends to reconnect this park with the whole city as a new step on a greener route. It plans a trail there dedicated to sport practice as well as a Pier of observation orientated toward the 'parc de la haute'. The development considered are only of a vegetal nature in order not to degrade the existing natural space.

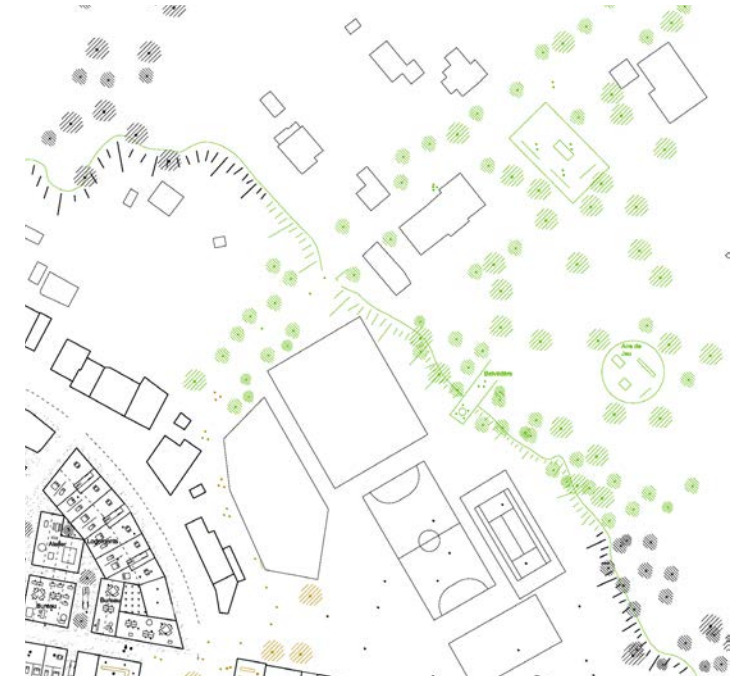
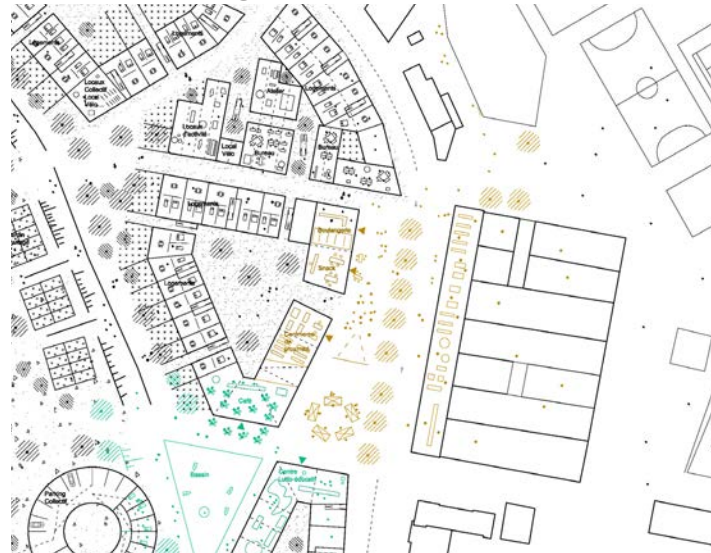
Parc des carrières**Parvis des Forges****Program :**

- Local shops
- Café/Snack
- School of forges
- Market/flea markets

Typology :

Contained space, square

Strategy :

- To dilate the industrial docks
- To define a square for the school

In front of the ancient forges is suggested a dilation of the public space edged with local shops (food, snack, café) and accommodations. Additionally to the new square provided to the school, this place is able to receive several types of neighborhood event such as flea markets, market or fair. The point here is to recover the urbanity that accompany the change of assignment of the industrial docks.

Program :

- Workshop with educational games around water theme
- Retention basin
- Café/Bistro

Typology :

Orientated space, riparian forest, small lake

Strategy :

- Maintenance of biological corridor of the Leignon
- Retention basin

The location of the Leignon is meant to reveal the natural wonder of the site. It also takes the role of a retention basin that can prevent flooding and is a nice opportunity to introduce a water space in the town. A center offering educational games around water management is planned to promote awareness and to maintain a rich ecosystem. It will also serve to link the greenway with the 'quai de l'industrie'.

Plan du Leignon

CINEY

Program :

- Artistic and cultural activities
- Plantations
- Parking

Typology :

Contained space in terraces, vegetal hillock

Strategy :

- Pedestrian link between 'parc de la haute' and the greenway
- Reinforcing the greenway

Edged in front of the rail by the cultural center, containing studios, loft and multipurpose rooms, the space will be able to be appropriated again as it will then be protected from the rails. By reinforcing the greenway, this park allows the creations of accommodations blocks. The existing hillock is reinforced to offer a space organized in terrace orientated toward the studios on one side and on the Leignon on the other. It can become the place for artistic performance while punctuating the crossing of the rails. A gateway from the roof of the museum makes it possible to cross the rails toward the 'parc de la haute'.

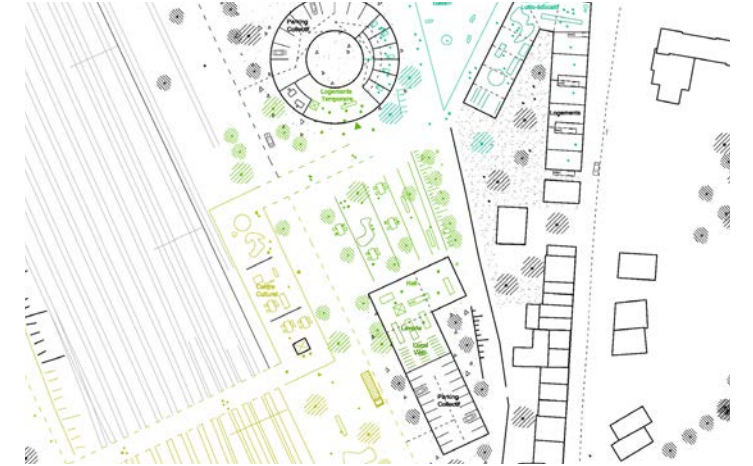
Scène végétale**Terminus****Program :**

- Bus station
- Skate park
- Parking
- Underpass

Typology :

Lined space, mineral platform

Strategy :

- To contain the city
- Crossing the rails and integrate them
- To join the 'parc la haute'

Additionally from allowing a diverse programmatic, this place generate new urban spaces from which the use can vary following the needs. Its position, between the rails and the 'parc de la haute' makes this latter accessible and create a new urban façade able to really integrate the railway elements of Ciney. Moreover, the place organizes new crossings. The first one, road like, is buried under the railways whereas the two others for pedestrians pass above the rails to join the rails on one side and the greenway on the other side.

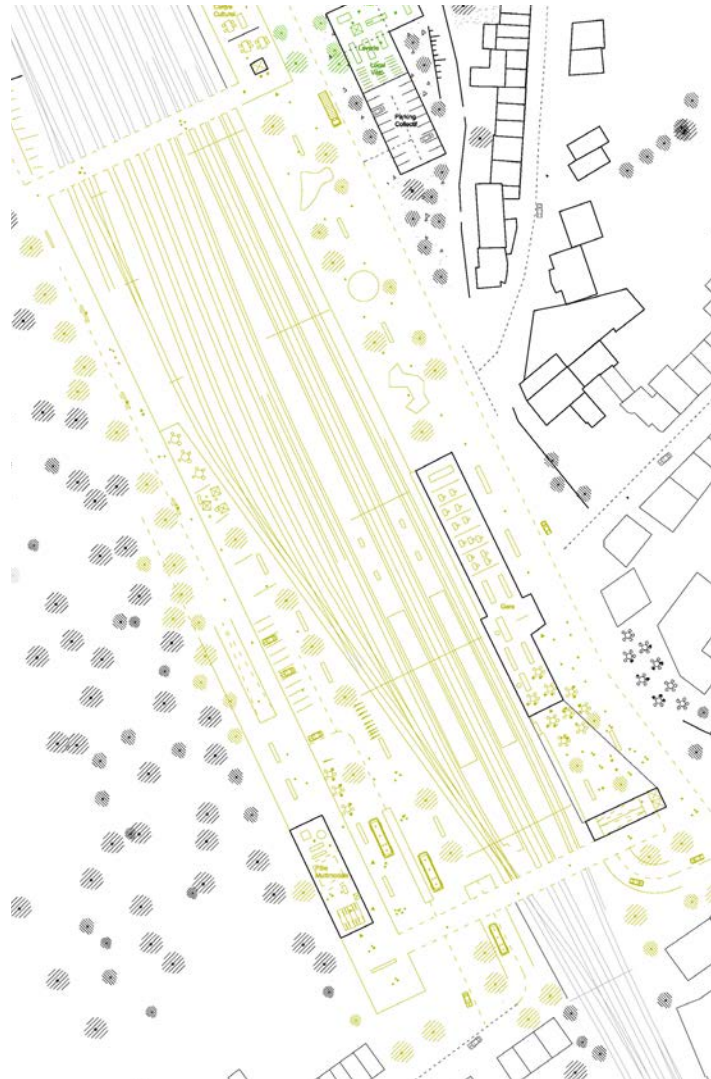

CINEY

Program :

- Agriculture administration/offices
- Multipurpose pole
- Accommodations
- Parking
- Promenade

Typology :

Post and beam structure, leaning linear building

Strategy :

- Programmatic diversity
- Adaptive framework
- A new façade of the town

The morphology of the new multipurpose pole answers two intentions:

- The first one, programmatic, is supposed to receive few departments of the agriculture's administration, accommodations but also parking spots. To the diverse nature of these expectations is born a structural framework able to accommodate different programs.

- The second intention, contextual, consists in creating a space able to blend the rails in the town by creating a link with the 'parc de la haute'.

The building will then elongate the trail near the railway, underneath which one will punctually be inserted the program that the town needs. Directly leaning against the 'parc de la haute', the roof is also an opportunity to offer a new wooden promenade that also opens sightseeing spot toward the town of Ciney.

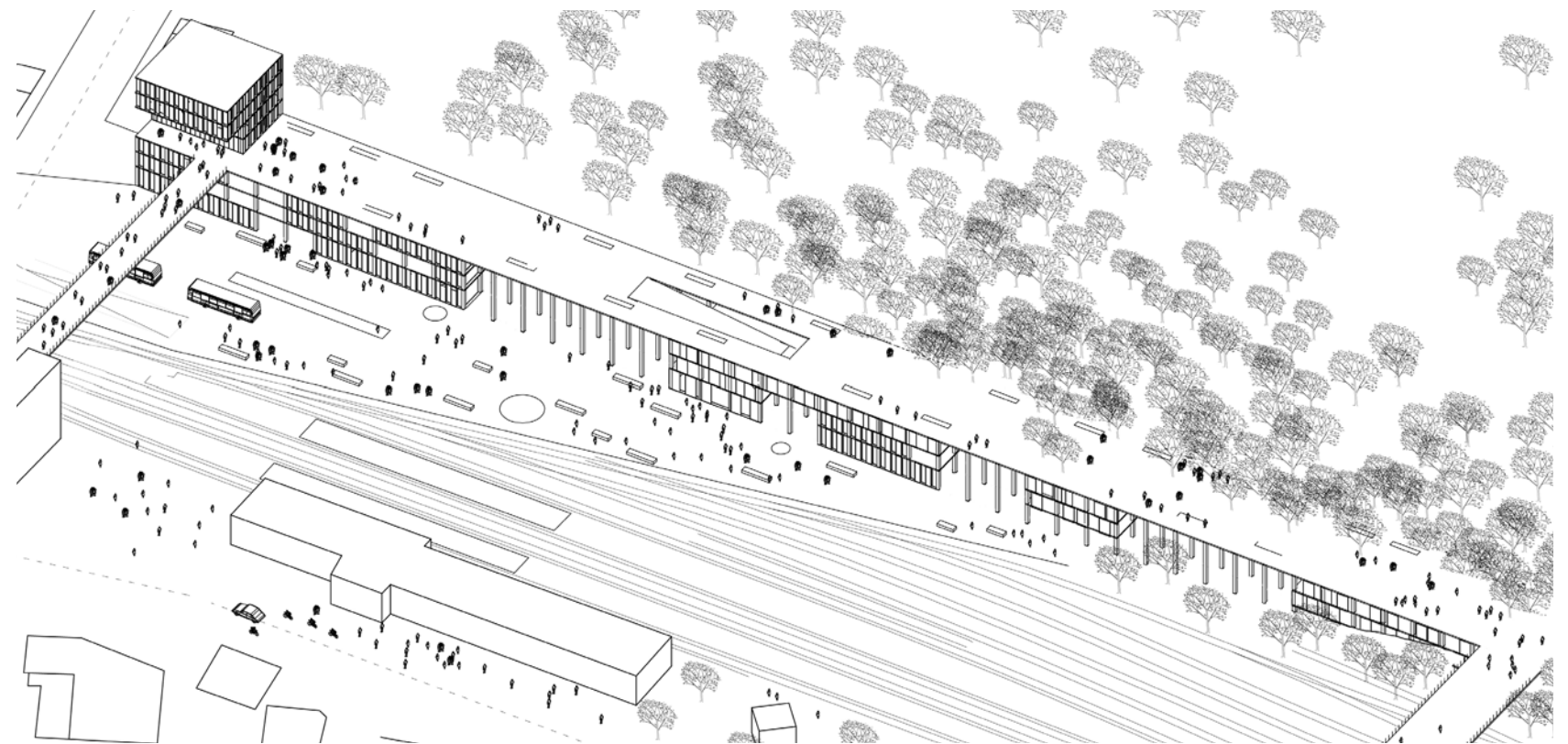
**Program :**

- Art gallery
- Train museum
- Artistic studio
- Accommodations

Typology :

Sheds, Studios, Lofts

Strategy :

- Requalify the border of the railways by an adapted program
- To protect from the noise pollution

The treatment of the border of the railways has been carried out by the choice of a program able to function despite the constraint while avoiding to reinforce the inhospitable character of the place.

The dynamic and dreamlike landscape of the railway has been found very suitable to develop a space for artistic creation and research. This project plans to install there several small cultural equipment such as galleries or a train museum. Studio and residence for artists will also make this border more alive by transforming it in an exhibition and performance space. The project site is therefore moved apart from the noise pollution by a stimulating filter.

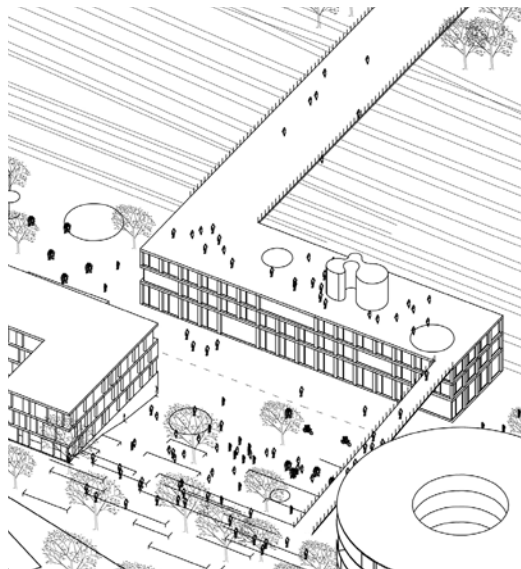

CINEY

Program :

- Offices
- Accommodations
- Activities

Typology :

Plot building, homeshared accommodation

Strategy :

- To let the greenway go 'wild'
- Diversify the built supply

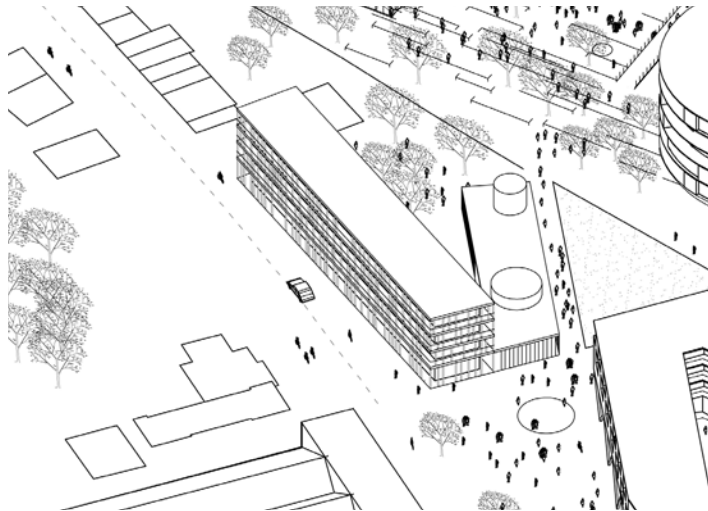
**Program :**

- Center with educational games
- Accommodations
- City house

Typology :

Street front, city house, duplex

Strategy:

- To reconstitute the «quai de l'industrie»
- Define a street profile

Program :

- Accommodations
- Local shops

Typology :

Collective block with courtyard, Stilts

Strategy :

- To dilate the «quai de l'industrie»
- Scale ratio with the forges

The presence of the greenway has directly orientated the geometry of the building and its establishment. The intention coming from one hand to maintain the important vegetal space (greenway) and on the other hand the will to make this one habitable. The project plays around this contradiction by combining both. The cylindrical shape permits that the route used by the vegetation will not be blocked. The shape lets the nature slides and joins the train station. The building is constituted of homeshared accommodation and offers plateaus articulated around space that can be appropriated by its inhabitant thanks such as collective kitchen, winter gardens but also terraces aiming to favor life in collectivity.

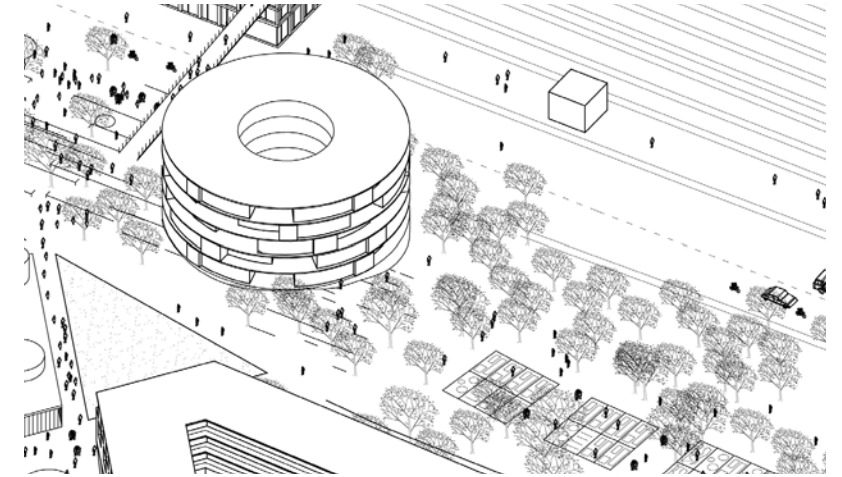

The reorientation of the 'quai de l'industrie' as a green circulation way permit to recover an urban way. In the continuation of the houses already present, this project plans to build city houses and accommodations in duplex facing directly the street while containing a tiny garden orientated toward the Leignon in the back. These buildings lead to the square of the forges on which one, it turns back at R+1 to come and edge with the basin of the Leignon in order to create a center with educational games around water management.

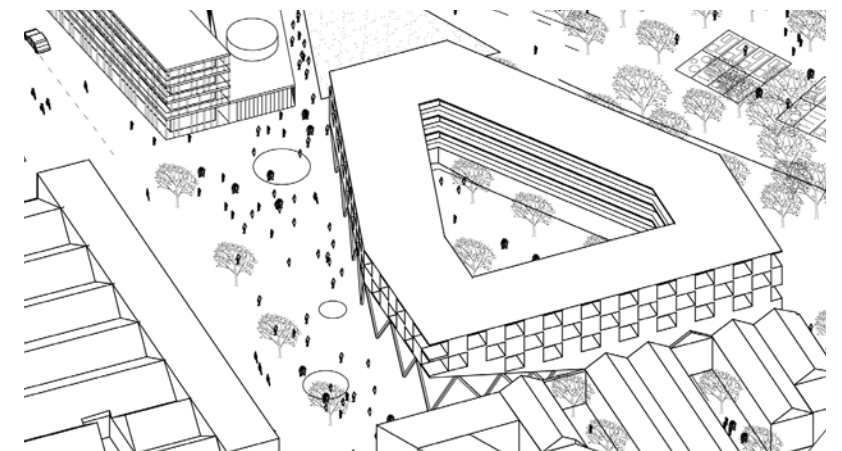

CINEY

Program :

- Offices
- Workshop
- Accommodations

Typology :

Shed, hangar, patio

Strategy :

- To spare what is existing
- Memories of the site

The ancient garages and shops of finished product from the forges are kept as structure of the mass plan and memories of the site. Currently occupied by accommodations and a gardening shop, they are reorganized to be added to local activities, offices and accommodations. The principle is to open several framework into patio and alleys to bring more light and suggest innovative typology adapted to what is existing.

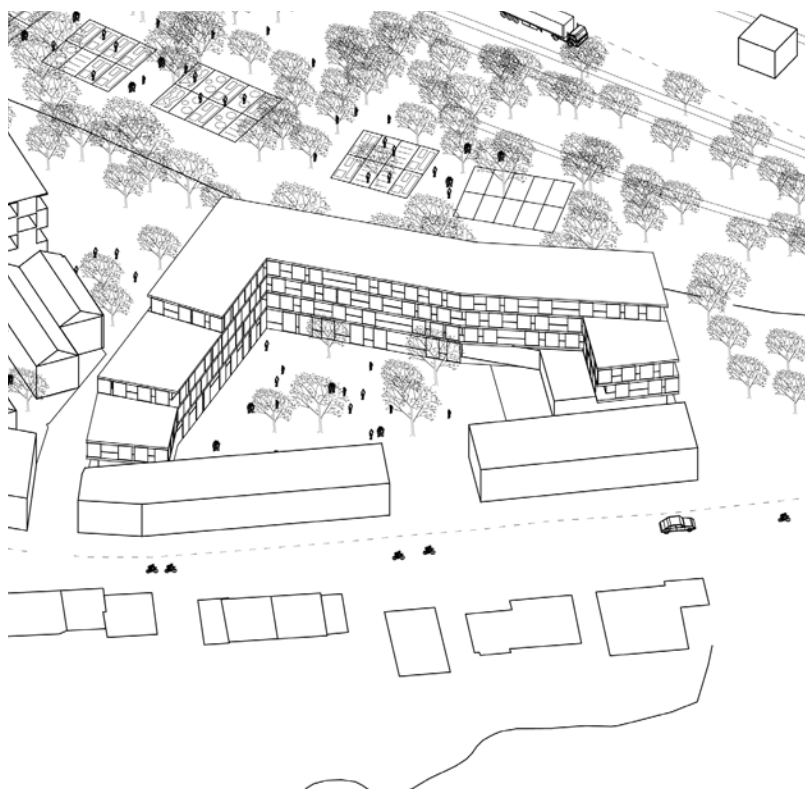
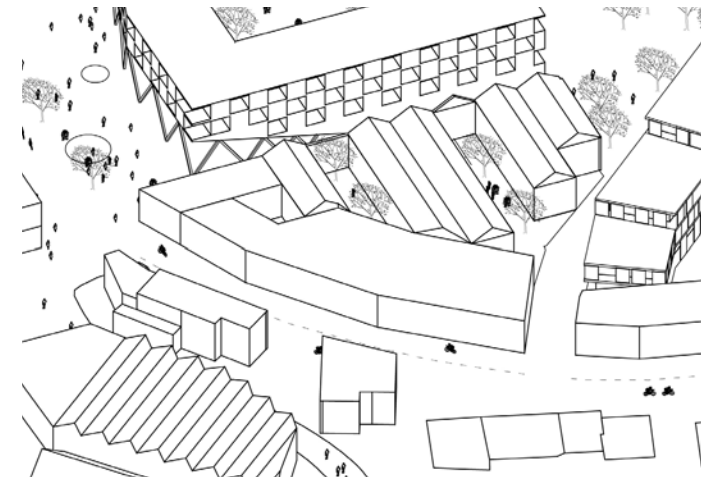
**Program :**

- Accommodations
- City house

Typology :

Building in terraces around courtyard

Strategy :

- Composed with what is existing
- To channel the greenway

In the northern part of the project, toward Yvoir, two other recently renovated building are kept. Located in front of the street, it composed a part of the façade from the «quai de l'industrie». The planned building is established as a U, that way it offers a planted courtyard in the back of the kept buildings. Its morphology in terraces offers on one side a large façade on the greenway and on the other side two smaller gables to fit the scale of the existing constructions.